

# LED Bulkhead Light IMPEL Series with Microwave Sensor & Emergency



LED Bulkhead Light IMPEL Series with Microwave Sensor & Emergency



## Product Dimensions:

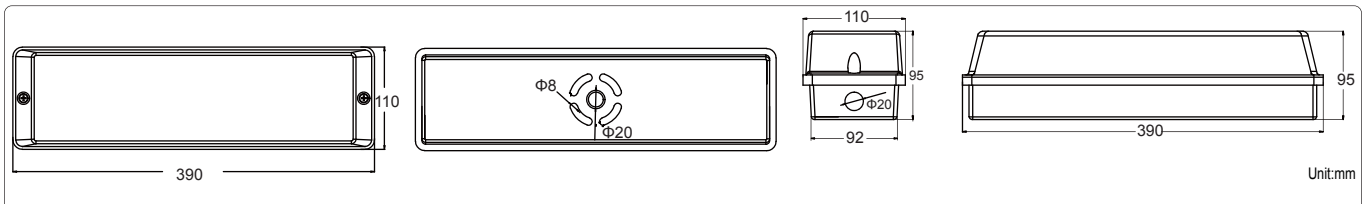

## Luminous Intensity Distribution Diagram & Lux Distribution:

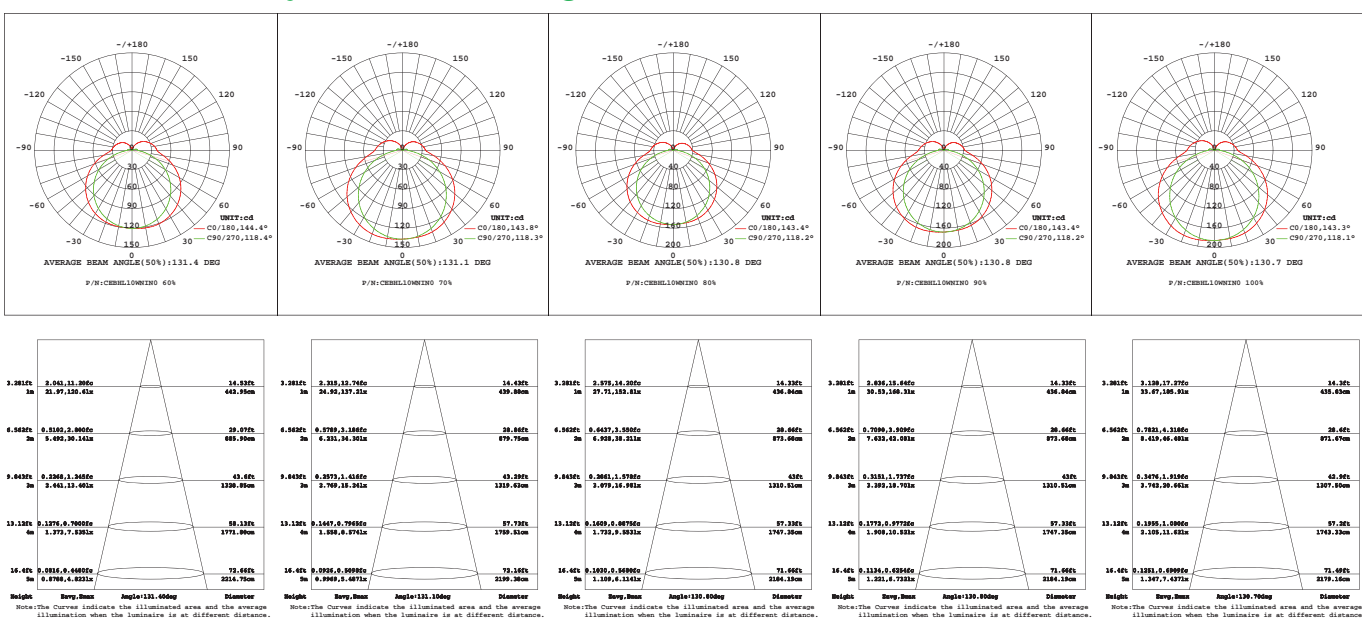

### Manufacturing Quality Standard:

- ISO 9001:2008
- LED Luminaire Standard:
  - EN/IEC 60598-1
  - EN/IEC 60598-2-1
  - EN/IEC 60598-2-2
  - EN/IEC 60529
  - EN/IEC 62471-2
  - IEC 62612
- EN/IEC 60968
- IEC 62560
- EN/IEC 60061-1
- EN 13032-1
- EN 13032-2
- EN/IEC 62471

### Electronic Driver Standard:

- EN/IEC 61347-1
- EN/IEC 61347-2-13
- EN/IEC 62384
- EN/IEC 61000-3-2
- EN/IEC 61000-3-3
- EN/IEC 61547
- EN 55015(CISPR 15)

### LED Module Standard:

- IEC 62031
- IEC 60838-2-2

### LED Light Photometric Standard:

- CIE, TM14; LM-75; IES; LDT; CEN; CIB

### RoHS Standard:

- EPA3050B
- EN 1122B
- IEC 62321
- EPA3052
- EPA3060A
- IESNA LM-79-08
- IESNA LM-80-08
- Switching cycle:100,000x
- EPA7196A
- EPA3540C
- EPA8270C

### LED Luminaire Performance:

- EN 60598-2-22
- EN 61347-2-7
- EN 60702-2
- BS 5266-1
- BS 6207-3

### Emergency Standard:

- With CELEX-LED Emergency System
- HKFSD PPA 104A(4th Revision)
- EN 60598-2-22
- BS 6387
- BS EN 60598-2-22
- EN 61347-2-7
- EN 60702-2
- BS 5266-1
- BS 6207-3



# LED Bulkhead Light IMPEL Series with Microwave Sensor & Emergency



## Detection Area

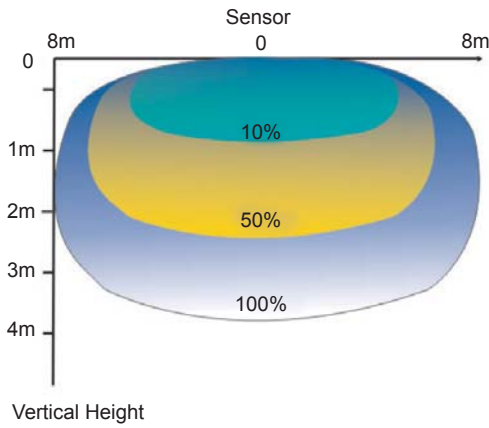

## Microwave Motion Sensor Technology & Corridor Function

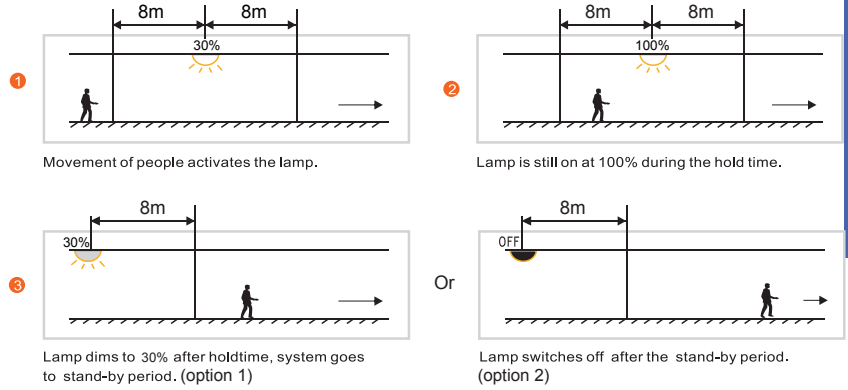

## Features:

- Wall-mounted & ceiling mounted
- High pressure die-casting 6063 aluminum alloy housing with electrostatic powder painting
- Silicon seal gasket for good Ingress Protection
- LED source comply with U.S.A IES LM-80-08
- Each LED module is independent working
- High power factor(> 0.9) and power efficiency(>0.85)design
- Fuse terminal design for short circuit protection
- Built-in constant current power supply
- Optional battery kit for emergency lighting
- Optional Microwave Motion Sensor

## Applications:

- Subway Lighting
- Stairway Lighting
- Corridor Lighting
- Eaves Lighting



## Specifications:

Power	7W / 10W / 12W
Input Voltage	AC 176~264V 50/60Hz
Power Factor	>0.9
Power Efficiency	>0.85
Total Harmonic Distortion	<20%
Luminaire Efficacy	* 75lm/w (2700K), * 80lm/w (3000K), * 90lm/w (4000K), * 95lm/w (5000K), * 100lm/w(6500K)
LED Source Efficacy	* 95lm/w (2700K), * 100lm/w (3000K), * 110lm/w (4000K), * 115lm/w (5000K), * 120lm/w (6500K)
Beam Angle(Horizontal/Vertical) Basing on LM-79-08	144° / 118° (0/180) (C90/270)
Operating Temperature	-20~50°C
LED Source	Samsung
Life Time LM-80-08 L70	50,000 Hours at Ta=40°C
Operating Humidity	10%~98% RH
Finishing Materials	Aluminum and Polycarbonate
Body Color	Matt White Housing and Milky Cover
Net Weight	1100g



# LED Bulkhead Light IMPEL Series with Microwave Sensor & Emergency



## Emergency Specifications:

Power Factor <small>(No Emergency LED Light Module)</small>	0.95
Light Source	LED SMD 3528 / 5630 / Samsung
Recharge Time	<12Hours
Discharge Time	>3Hours
Input Voltage	AC 176~264V or 100~120V (50/60Hz)
Battery	9.6V 2.2AH/Ni-MH Rechargeable Battery
Emergency Output Power	>30%
Transfer Time	<3.0 Second
Test Button	In AC mode, push and hold the button to test the emergency mode, release to normal
Operation Temperature	-20°C ~ 50°C
Housing Materials	Polycarbonate Cover
Humidity	0~95%(IP65)
Net Weight	3.8kg

## Motion Detection Range:

High-Frequency System	5.8GHz
Detection Angle	155°
Detection Distance	Up to 8m
Motion Detection Range	1km/h to 10 km/h
Time Setting	10sec to 5min
Lux Control	2~2000Lux
Lumen Output Control	0~100%

## Installation Guide:

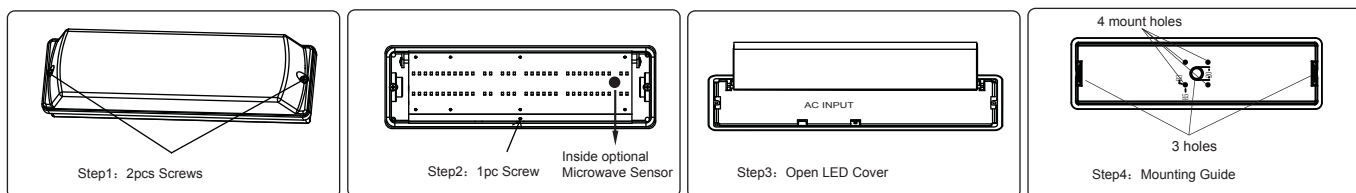

## Ordering Part No.:

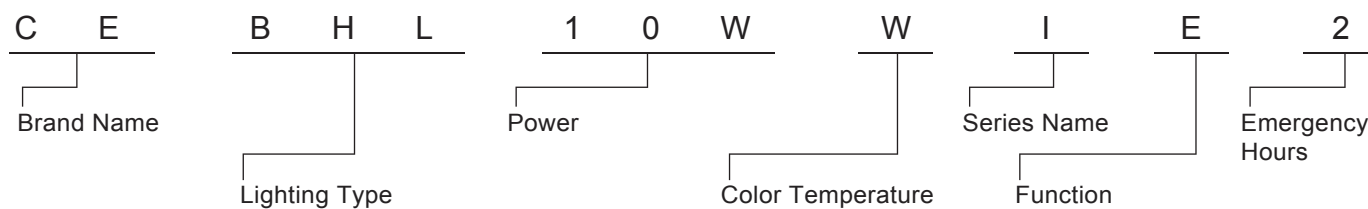

Brand Name	Lighting Type	Power	Color Temperature	Series Name	Function	Emergency Hours
CE: CELEX	BHL: Bulkhead Light	07W 10W 12W	O: 2700K W: 3000K N: 4000K D: 5000K C: 6500K	I: IMPEL Series	E: Emergency M: Microwave EM: Emergency & Microwave N: Switch In	0 2 3 4

